



# CLIMAX COFFEE Pty Ltd

Manufacturers of Australian Made CLIMAX Coffee Grinders

## Climax Coffee Grinder L series



### Specifications

**Machine Dimensions:** H 590mm W 195mm D 315mm

**Grinding Capability:** From Turkish to Plunger infinite adjustment

**Grinding Burrs:** Flat 75mm Diameter

**Grind Capacity:** 300g per minute set on medium grind

**Hopper:** Stainless Steel 750g Capacity

**Colours:** Black, Silver, Beige or Stainless Steel

**Motor:** Australian Made 1/2h.p. 230/250v Single Phase

Climax Coffee Grinder

Made In Melbourne Australia For Over 65 Years

# Climax Coffee Grinder L series

## Operating Instructions

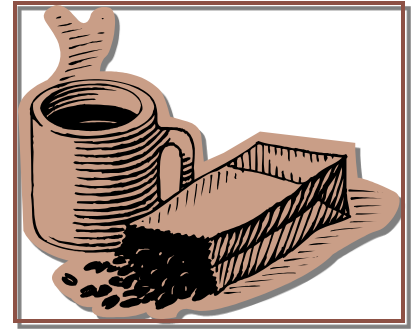

Dear Customer,

We congratulate and thank you for your purchase of our Climax Coffee Grinder L series.

These operating instructions have been prepared to simplify your use of the coffee grinder. They contain information and instructions for the best use of your unit.

**The Climax Coffee Grinder is a quality product but cannot be excluded from damaging or the risk of injury if misused or operated improperly.**

---

- 1. The Climax Coffee Grinder L series** is suitable for grinding various types of coffee. By adjusting the knob you can set the grinding fineness which ranges from “Turkish fine” to “coarse”.

The machine is designed to grind coffee but can grind other things like herbs and nuts. Although the machine might clog if the moisture content is greater than coffee, cleaning all foreign material from the inside the cutter compartment will restore the grinder to its original condition.

### **2. How to use the Climax Coffee Grinder.**

- Make sure there are no coffee beans in the hopper or grinding chamber, if unsure turn the grinder on(L025), any left over residue from previous grinds will flow through the burrs(L011), when this is done turn machine off(L025).
- Set the grinding fineness for the coffee with the selection knob(L014) 0 Finest (Turkish) to 5 Coarse.
- Slide open the Lid (L001) and place the coffee beans in the hopper.
- Place the bag or container below the spout you must place the bag between the spout and the bag holder (L022) spring loaded clamp.
- Press the ON/OFF switch (L025).
- When grinding is finished switch off the grinder.
- Remove container.

Climax Coffee Grinder  
Made In Melbourne Australia For Over 65 Years

This machine is fitted with an automatic thermo trip which will cut off power to the motor if the motor overheats. (E.g. A hard body such as a stone preventing the cutters from turning) As the thermo trip will reset after about 20 seconds and the machine will turn on. To avoid burning out the motor please switch machine off at the on/off switch or on the wall outlet, then remove the obstruction.

### 3. Care / Maintenance / Adjustment

- Care and Cleaning of coffee Grinder

The coffee grinder should be cleaned at least once a week and always if soiled. Only clean the coffee grinder with a dry cloth.

**Do not** use an alkaline cleaning agent

**Do not** spray the coffee grinder with water and/or steam.

Using these can result in a short circuit of the machine risking permanent damage. The use of an alkaline cleaning agent can also alter the taste of the coffee.

- Maintenance

If the quality of the grinder is no longer at the required standard, the grinding burrs must be replaced.

The burrs should also be inspected for wear annually.

Don't attempt to inspect the quality of the grinding disks by yourself. Always get a competent specialist and/or service personnel to do it for you.

- Grinder calibration

Calibration of the grinder (with the setting nut) makes the fineness of the ground coffee correspond with the fineness set on the scale (marked)

Calibration of the grinder must only be performed by persons familiar with the unit after carefully reading the following instructions.

- Basic calibrations should be made after replacing the grinding burrs, following inadvertent displacement of the basic calibration.

#### 4. Basic Calibration

If the calibration of the grinder is incorrect friction can occur between the grinding burrs, resulting in excessive wear.

- Turn large black knob(L014) anti clockwise till it stops
- Place two levers one left, the other right, under the grind setting knob pull gently
- Large black knob will slide off its serrations
- Turn the grinder on (L025)
- Gently turn the serrated setting nut (L013) clockwise until you hear the burrs coming into contact, mark this position with a marker on the body and on the screw, rotate setting nut (L013) anti clockwise 12mm from this position.
- Place a handful of coffee beans in the hopper, the following grind should be Turkish if this is not to your personal liking then you can adjust the setting screw plus or minus 5mm no more. **DO NOT ADJUST THE SETTING SCREW MORE THAN 5MM CLOCKWISE AS THIS COULD DAMAGE YOUR BURRS**
- When the setting is correct or to your liking turn grinder OFF(L025), fit the black setting knob(L014) by aligning the inside fin of the knob to the left side of the tab on front cover and the outside indicator of the knob to the scale 0 setting, push firmly onto serrations. Move knob anti clockwise and clockwise, check that it comes to a stop at 0 and at 5 on the setting scale.
- Check your setting and tag if required.

When the grinder is ON, turning the setting knob from scale position 0 – 5, there must be no sound of metal parts rubbing together.  
If there is the sound of rubbing metal, it could equal excessive wear or damage of the grinding burrs.

## 5. Replacing grinding discs

**Before changing grinding burrs switch off the motor and pull the power cable out of its socket.** Grinding burrs must only be replaced by persons familiar with operation of the machine according to the following instructions.

- Switch off (L025) the motor and pull out the power cable.
- Dismantle top cover (L002), 2 screws on each side use 2.5mm hex key.
- Remove selection knob (L014), place two levers under the grind selection knob, pull gently large black knob will slide off its serrations.
- Remove front cover (L009), 2 screws top and bottom inside cover, main body side, use 2.5mm hex key.
- Remove setting nut (L013) unwind anti clockwise until removed.
- Remove tension spring screw (L015), use 5mm hex key.
- Remove tension spring (L016), slide out one side then the other side.
- Remove Hopper (L007), 2 screws centrally located use 2.5mm hex key.
- Remove agitator spring (L012), 1 screw centrally located at top of cutter housing (L023) chamber, use 3mm hex key.
- Pull out stationary cutter hub (L017) remove burr, 3 screws use 5mm hex key. Clean thoroughly as any dirt under the cutter could affect the quality of the grind. Place new burrs in position and screw in place.
- Remove Burr (L011) from rotating cutter hub (L010), 3 screws use 5mm hex key. Clean thoroughly as any dirt under the cutter could affect the quality of the grind. Place new burrs in position and screw in place.
- Then re-assemble parts in reverse sequence. Tighten all screws.
- Plug in power cable, switch on coffee grinder briefly. If it blocks or there is the sound of metal parts rubbing together, disassemble and check.
- Setting must be re-adjusted as per 4 Basic Calibration.

The CLIMAX COFFEE GRINDER is a precision machine, if the above instructions are adhered to, we are confident that it will give many years of trouble free service.

Climax Coffee Grinder  
Made In Melbourne Australia For Over 65 Years

If further information or assistance is needed, please contact.

## Climax Coffee

Fax: 64 03 94663912 Email: [Info@climaxcoffee.com.au](mailto:Info@climaxcoffee.com.au)

Address: 10 Ivanhoe Court Thomastown Vic 3074 Australia

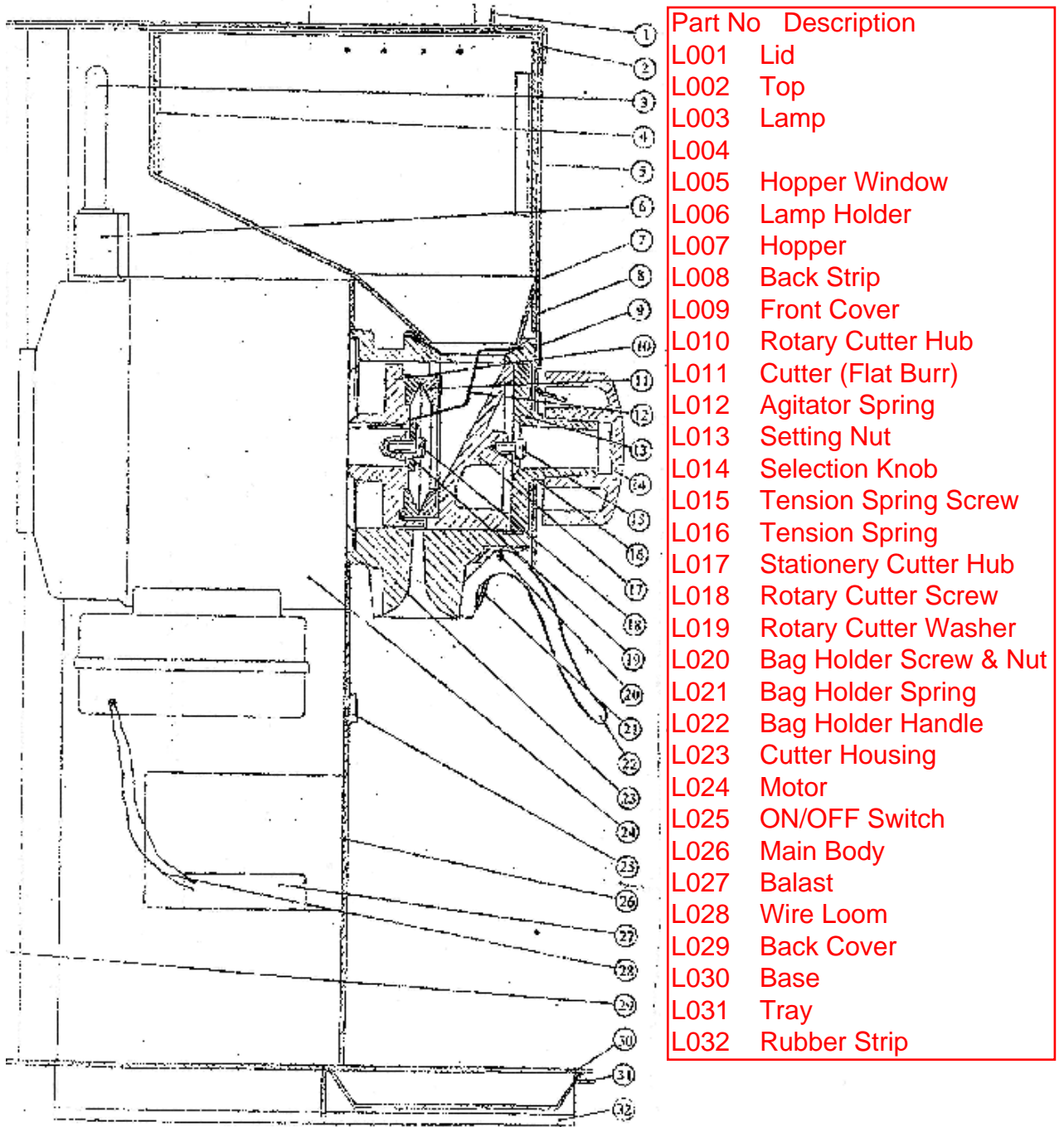

Climax Coffee Grinder

Made In Melbourne Australia For Over 65 Years